

# Unidrive M600-M70X, F300, H300, E200 & E300 Size 3 Tile Mounting Installation Sheet

## 1 Safety information



### Follow the instructions

The mechanical and electrical installation instructions must be adhered to. Any questions or doubt should be referred to the supplier of the equipment. It is the responsibility of the owner or user to ensure that the installation of the drive and any external option unit, and the way in which they are operated and maintained, comply with the requirements of the Health and Safety at Work Act in the United Kingdom or applicable legislation and regulations and codes of practice in the country in which the equipment is used.



### Competence of the installer

The drive must be installed by qualified personnel only, who are familiar with the requirements for safety and EMC. The installer is responsible for ensuring that the end product or system complies with all the relevant laws in the country where it is to be used.

## 2 Introduction

This document covers 'Tile Mounting' instructions for Unidrive M600 / M70X, F300, H300, E200 & E300 size 3 drives.

### Contents of the box (3470-0049-00)

The following items are supplied in the 'Tile Mounting Kit'.

Description	Image	Quantity
Keypad Tile Mounting Bracket*		x 1
Tile Mounting Upper Bracket		x 1
Tile Mounting Lower Bracket		x 1
M5 x10 fasteners**		x 8
Tile Mounting Installation Sheet		x 1

\* This bracket is not required if the keypad is physically mounted on the drive or if the keypad is not used.

\*\* Eight fasteners are supplied. Four of the fasteners are used for tile mounting the drive, out of the remaining four fasteners, two are used for securing the keypad tile mounting bracket (if used) as described in **Step 1**, the other two are used for installing the keypad mounting bracket (supplied separately) to the keypad tile mounting bracket.

### Additional items required

The following items are included in accessory kits: 3470-0038 and 3470-0042, either of which are supplied with the drive.

Description	Image	Quantity
Frame 3 Mounting Bracket		x 2

## 3 Instructions

### STEP 1 - Preparing the Upper Mounting Assembly

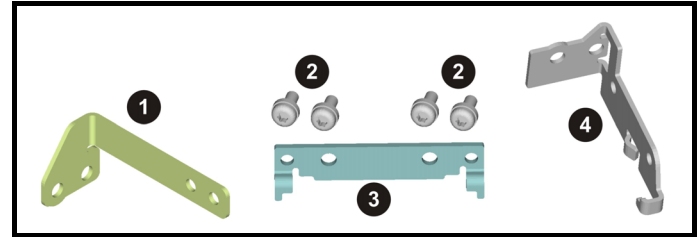

You will require the above parts as listed below:

1. Keypad Tile Mounting Bracket (see note)
2. M5 Fasteners x 4
3. Frame 3 Mounting Bracket
4. Tile Mounting Upper Bracket

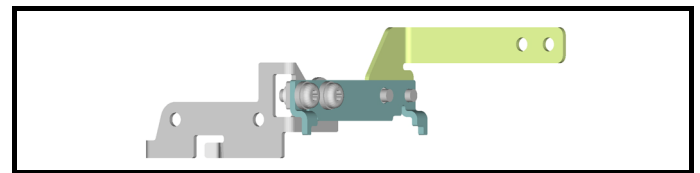

Assemble the brackets (shown in step 1) using M5 fasteners provided. The M5 fasteners should be tightened to a maximum torque of 2.5 N m (22.1 lb in).

### STEP 2 - Preparing the Lower Mounting Assembly

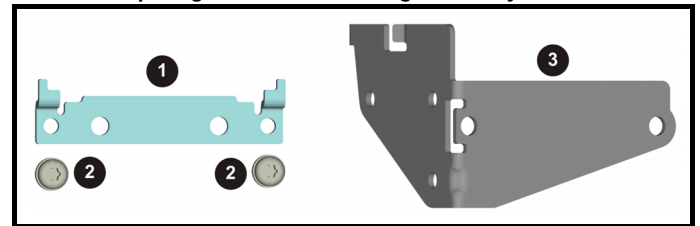

You will require the above parts as listed below:

1. Frame 3 Mounting Bracket
2. M5 fasteners x 2
3. Tile Mounting Lower Bracket

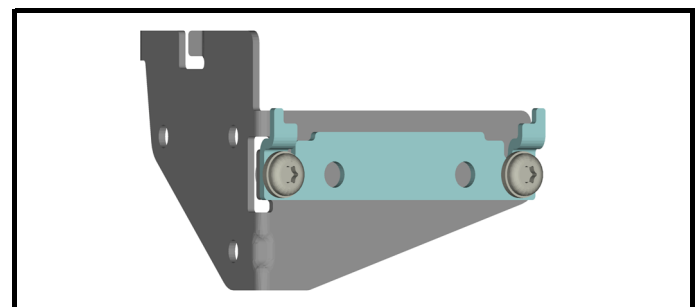

Assemble the brackets (shown in step 2) using M5 fasteners provided. The M5 fasteners should be tightened to a maximum torque of 2.5 N m (22.1 lb in).



0478-0007-03

**STEP 3 - Preparing the Backplate / Mounting Plate**

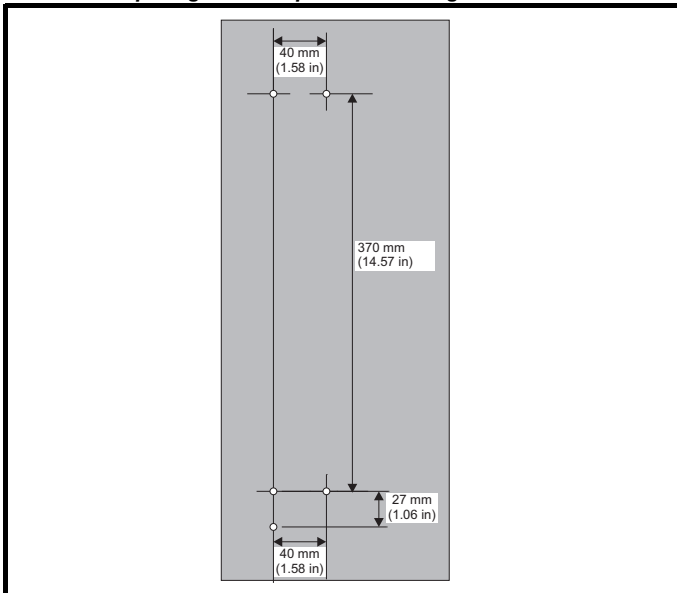

Prepare the backplate / mounting plate as per the mounting dimensions shown above.

**STEP 4 - Installing the Lower Mounting Assembly**

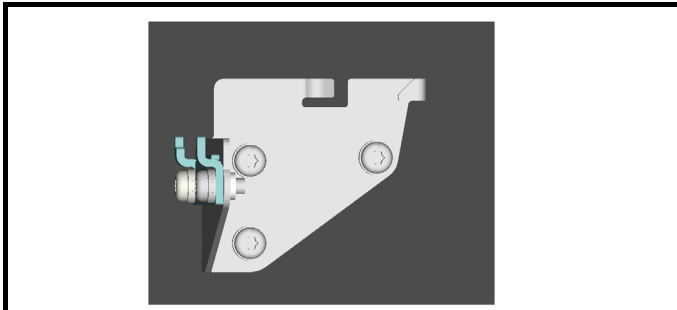

Secure the lower mounting assembly to the backplate / mounting plate using suitable M5 fasteners x 3 (not supplied).

**STEP 5 - Installing the drive**

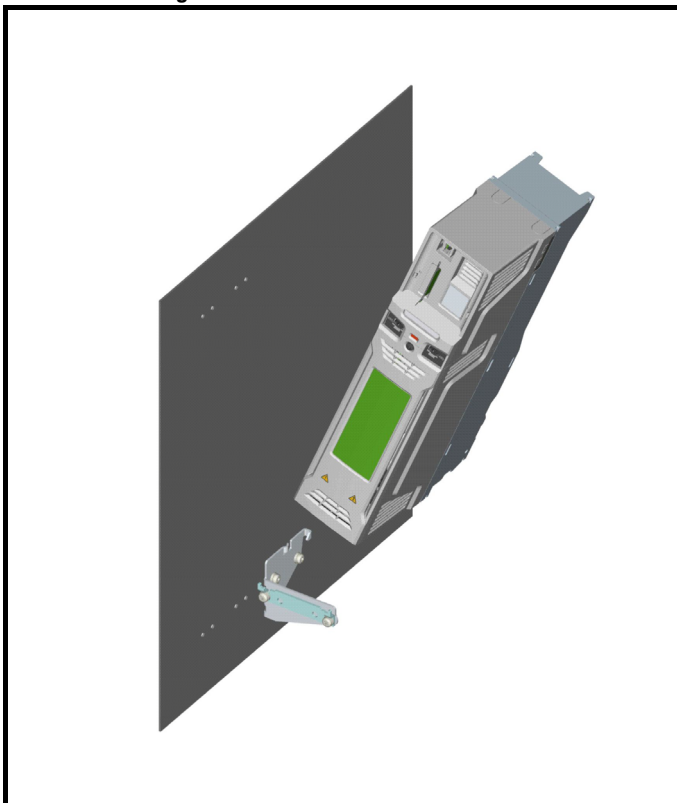

Offer the drive up to the lower mounting assembly at a slight approach angle.

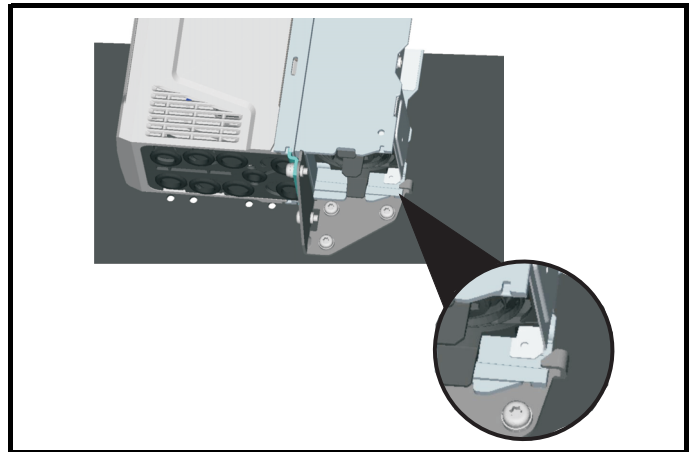

Pivot until the tab on the right hand side of the 'Tile Mounting Lower Bracket' locates on the chassis below baffle plate. Ensure the tab is fully engaged.

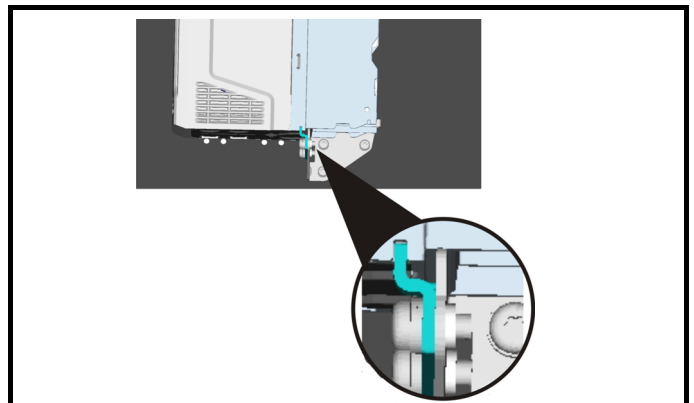

Locate the mounting bracket into the drive chassis lower mounting slots. Ensure the drive is supported at all times.

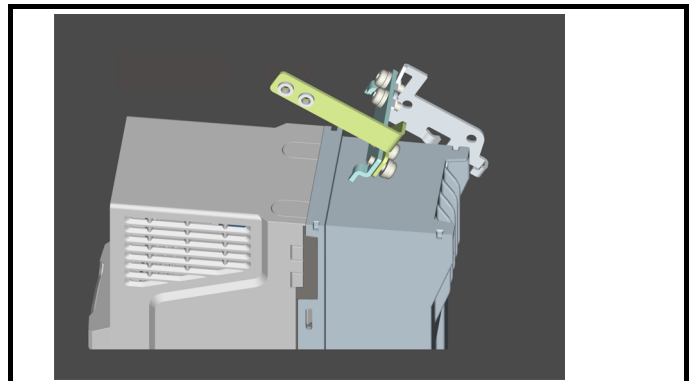

Align upper bracket assembly at approximately 30° to the drive.

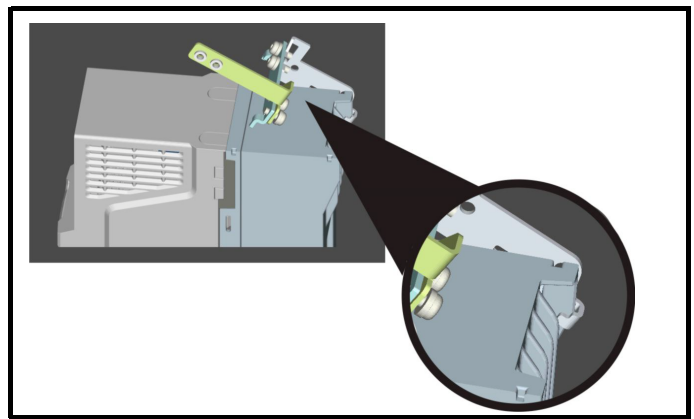

Pivot the upper mounting bracket assembly until the bottom tab on the bracket locates under chassis lip as highlighted above.



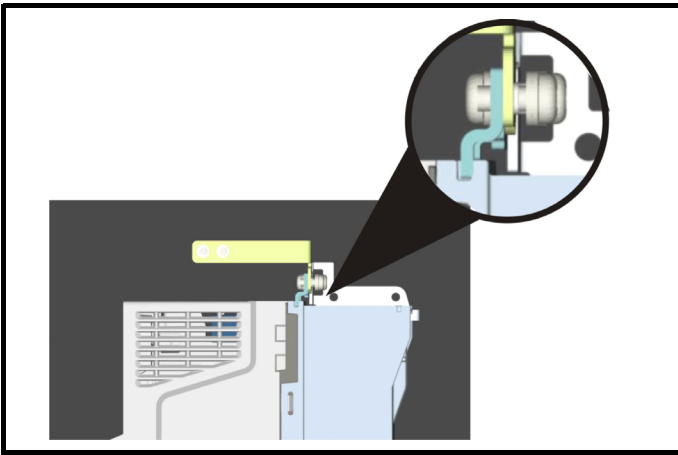

Locate the mounting bracket tabs into the chassis upper mounting slots. Ensure both tabs are fully engaged.

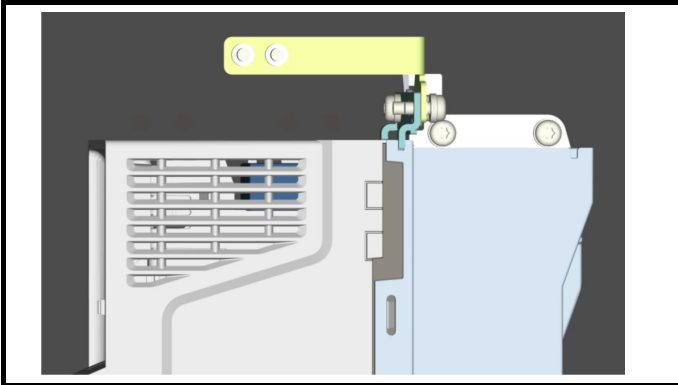

Attach the upper mounting assembly to the mounting plate using suitable M5 fasteners x 2 (not supplied).

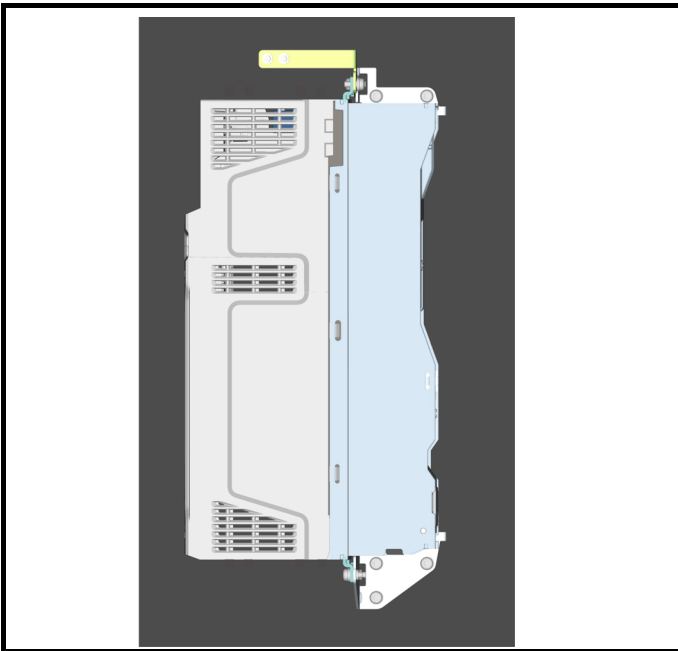

The above graphic shows the completed installation of 'Tile Mounting'.



0478-0007-03